





## GEWINDEHÜLSEN – ABMESSUNGEN UND KERNLOCHDURCHMESSER

d	D	L	
<b>M 2 x 0,4</b>	M 4,5 x 0,5	6	4,2
<b>M 2,5 x 0,45</b>	M 4,5 x 0,5	6	4,2
<b>M 3 x 0,5</b>	M 5 x 0,5	6	4,7
<b>M 4 x 0,7</b>	M 6,5 x 0,75	8	6,1
<b>M 5 x 0,8</b>	M 8 x 1,0	10	7,5
<b>M 6 x 1,0</b>	M 10 x 1,5	14	9,3
<b>M 8 x 1,25</b>	M 12 x 1,5	15	11,4
<b>M 10 x 1,5</b>	M 14 x 1,5	18	13,25
<b>M 12 x 1,75</b>	M 16 x 1,5	22	15,25
<b>M 14 x 2,0</b>	M 18 x 1,5	24	17,0
<b>M 16 x 2,0</b>	M 20 x 1,5	22	19,0
<b>M 18 x 2,5</b>	M 22 x 1,5	24	21,0
<b>M 20 x 2,5</b>	M 26 x 1,5	27	25,0
<b>M 22 x 2,5</b>	M 26 x 1,5	30	25,0
<b>M 24 x 3,0</b>	M 30 x 1,5	30	29,0
<b>M 27 x 3,0</b>	M 34 x 1,5	30	33,0
<b>M 30 x 3,5</b>	M 36 x 1,5	40	35,0

d	D	L	
<b>UNC 4 x 40</b>	M 5 x 0,5	6	4,7
<b>UNC 6 x 32</b>	M 6 x 0,75	8	5,6
<b>UNC 8 x 32</b>	M 6,5 x 0,75	8	6,1
<b>UNC 10 x 24</b>	M 8 x 1,0	10	7,5
<b>UNC 1/4 x 20</b>	M 10 x 1,5	14	9,3
<b>UNC 5/16 x 18</b>	M 12 x 1,5	15	11,4
<b>UNC 3/8 x 16</b>	M 14 x 1,5	18	13,25
<b>UNC 7/16 x 14</b>	M 16 x 1,5	22	15,25
<b>UNC 1/2 x 13</b>	M 18 x 1,5	22	17,0
<b>UNC 5/8 x 11</b>	M 20 x 1,5	22	19,0

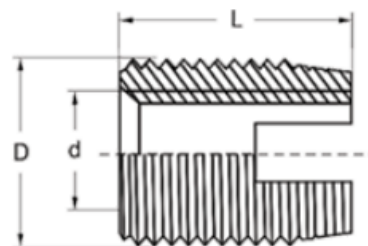

d	D	L	
<b>BSW 1/4 x 20</b>	M 10 x 1,5	14	9,3
<b>BSW 5/16 x 18</b>	M 12 x 1,5	15	11,4
<b>BSW 3/8 x 16</b>	M 14 x 1,5	18	13,25
<b>BSW 7/16 x 14</b>	M 16 x 1,5	22	15,25
<b>BSW 1/2 x 13</b>	M 18 x 1,5	22	17,0
<b>BSW 5/8 x 11</b>	M 20 x 1,5	22	19,0

d	D	L	
<b>UNF 4 x 40</b>	M 5 x 0,5	6	4,7
<b>UNF 6 x 40</b>	M 6 x 0,75	8	5,6
<b>UNF 8 x 36</b>	M 6,5 x 0,75	8	6,1
<b>UNF 10 x 32</b>	M 8 x 1,0	10	7,5
<b>UNF 1/4 x 28</b>	M 10 x 1,5	14	9,3
<b>UNF 5/16 x 24</b>	M 12 x 1,5	15	11,4
<b>UNF 3/8 x 24</b>	M 14 x 1,5	18	13,25
<b>UNF 7/16 x 20</b>	M 16 x 1,5	22	15,25
<b>UNF 1/2 x 20</b>	M 18 x 1,5	22	17,0
<b>UNF 5/8 x 18</b>	M 20 x 1,5	22	19,0